

HARDWOOD LAKE OGEMAW COUNTY, MICHIGAN JUNE 27, 2019 TREATMENT MAP

□ = 1 ACRE

Legend

- 2,4-D Ester = 0.25 acre of non-native milfoil w/Navigate @ 150 lbs./acre
- Clipper/Diquat = 2.25 acres of mixed exotics w/flumioxazin @ 100 ppb w/diquat-dibromide
- Triclopyr Dry = 0.75 acre of non-native milfoil w/Navitrol granular @ 200 lbs./acre
- Triclopyr Liquid = 1 acre of non-native milfoil w/Navitrol liquid @ 4 gallons/acre

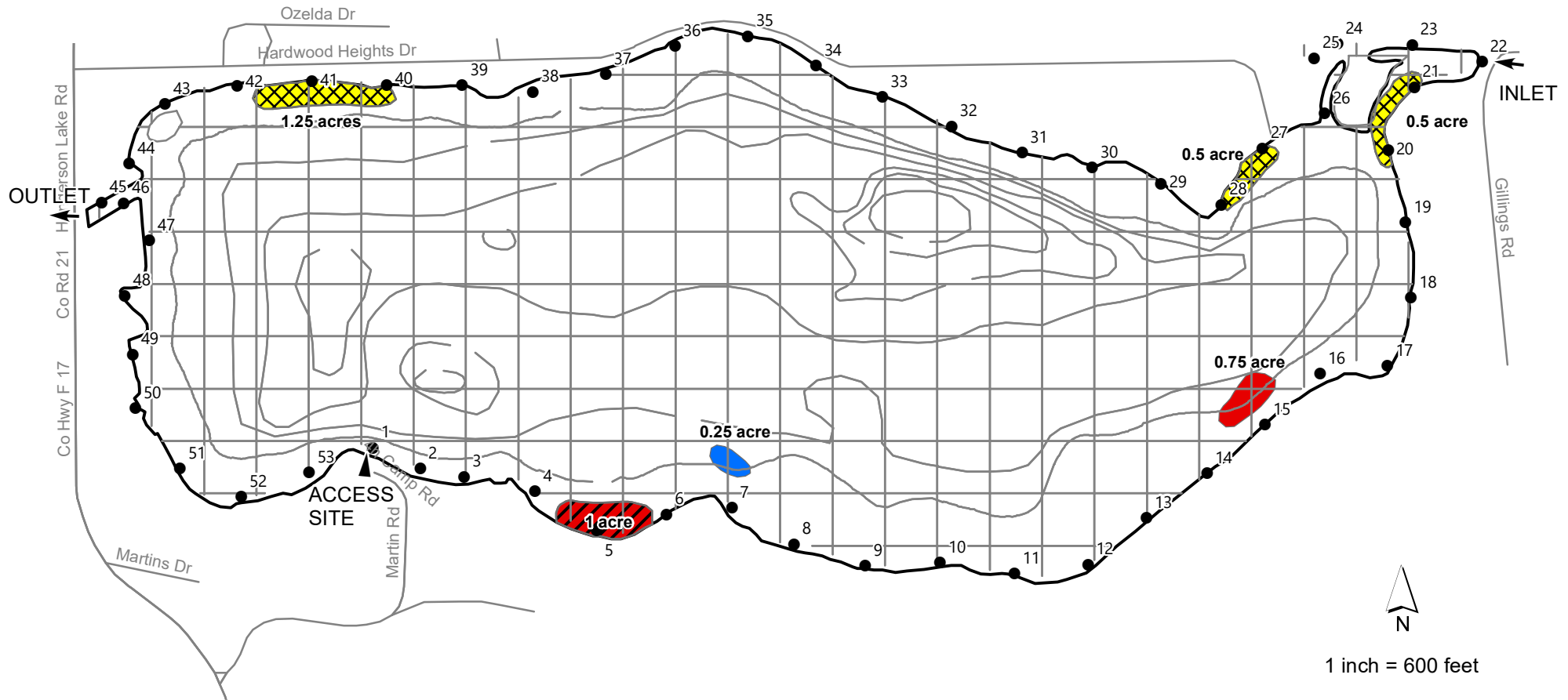

1 inch = 600 feet

TOTAL LAKE AREA = 182 ACRES
 REVISION DATE: FEBRUARY, 2018
 DEPTH CONTOUR SOURCE - MICHIGAN CONSERVATION DEPARTMENT 1943.