

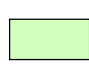

# HARDWOOD LAKE OGEMAW COUNTY, MICHIGAN JUNE 14, 2018 TREATMENT MAP

□ = 1 ACRE

## Treatment

 Algae = 18.75 acres of nuisance filamentous algae w/CuSO4

 Triclopyr Dry = 4.5 acres of non-native milfoil w/Navitrol granular at 200 lbs./acre

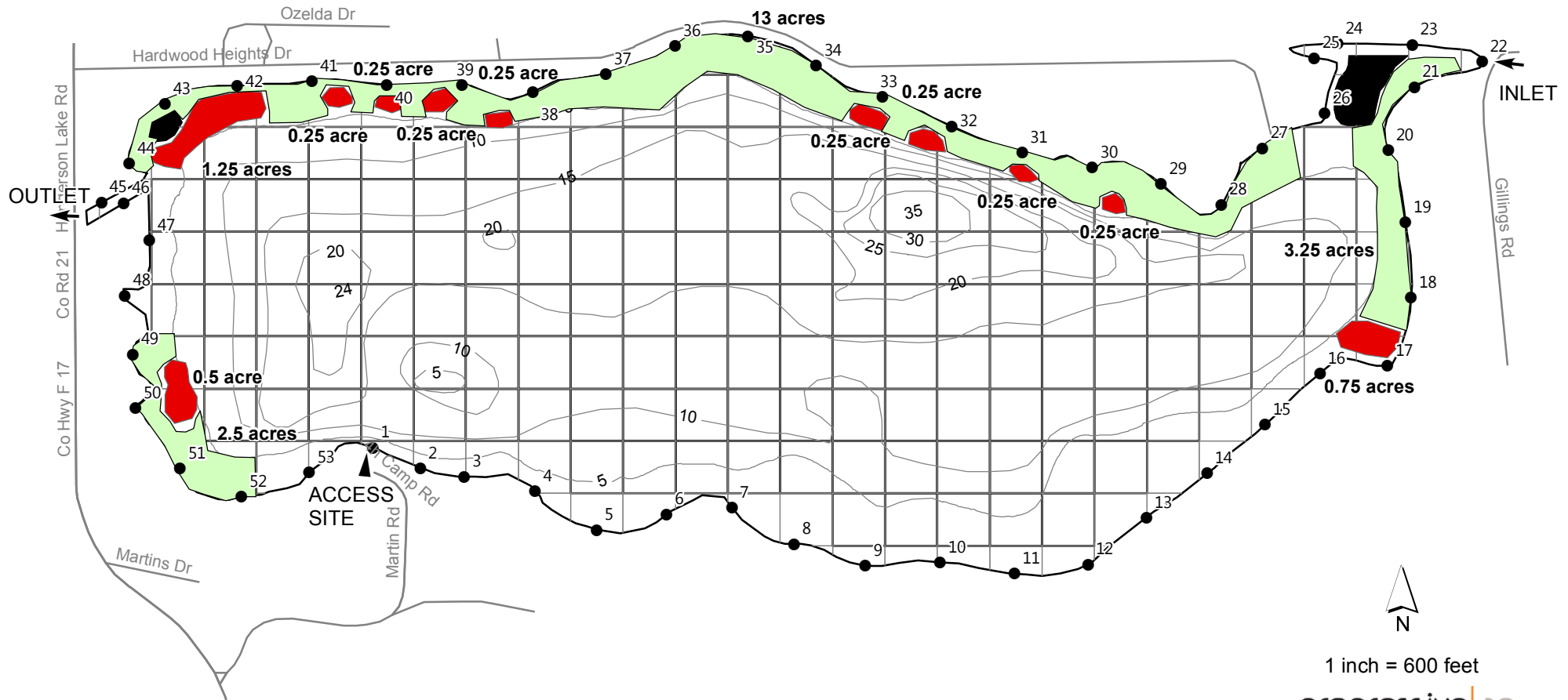

TOTAL LAKE AREA = 182 ACRES  
 REVISION DATE: FEBRUARY, 2018  
 DEPTH CONTOUR SOURCE - MICHIGAN CONSERVATION DEPARTMENT 1943.

1 inch = 600 feet  
 progressive|ae