

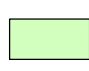

HARDWOOD LAKE OGEMAW COUNTY, MICHIGAN JULY 25, 2019 TREATMENT MAP

□ = 1 ACRE

Legend

 Algae = 13.75 acres of nuisance filamentous algae w/CuSO4

 Clipper/Aquathol-K = 2 acres of nuisance thin-leaf pondweed w/flumioxazin @ 100 ppb w/Aquathol-K

 Clipper/Diquat = 1.75 acres of milfoil/coontail w/flumioxazin @ 100 ppb w/diquat-dibromide

 Water Lily Control = 13 units for lily pad control with Imazapyr

 Triclopyr Liquid = 1 acre of non-native milfoil w/Navitrol liquid @ 4 gal./acre

 Copper/Hydro = 2.5 acres of starry stonewort w/CuSO4/Hydrothol 191 tank mix

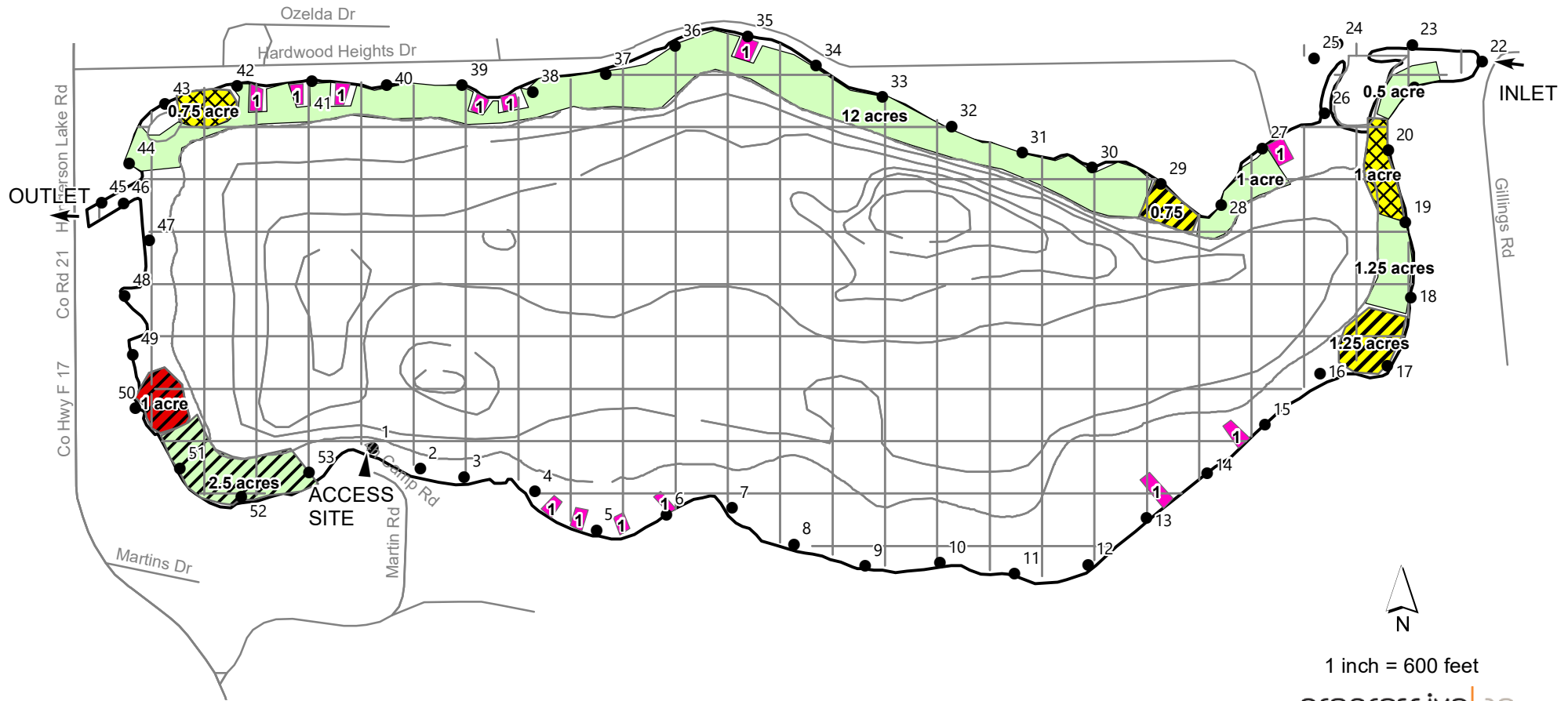

1 inch = 600 feet

progressive|ae

TOTAL LAKE AREA = 182 ACRES

REVISION DATE: FEBRUARY, 2018

DEPTH CONTOUR SOURCE - MICHIGAN CONSERVATION DEPARTMENT 1943.