

Date: 7-15-16

Crew: PJH, SAC, DAVE SOMMERS

Weather: MOSTLY CLOUDY, 68°F

HARDWOOD LAKE OGEMAW COUNTY, MICHIGAN AQUATIC PLANT SURVEY MAP

182 ACRES

□ = 1 ACRE

Plant Names

- 1 E. Milfoil
- 2 Curly leaf pndwd
- 3 Chara
- 4 Thinleaf pndwd
- 5 Flatstem pndwd
- 6 Robbins pndwd
- 7 Variable pndwd
- 8 Whitestem pndwd
- 9 Richardsons pndwd
- 10 Illinois pndwd
- 11 Large leaf pndwd
- 12 American pndwd
- 13 Floating leaf pndwd
- 14 Water stargrass
- 15 Wild celery
- 16 Sagittaria
- 17 Northern milfoil
- 18 M. verticillatum
- 19 M. heterophyllum
- 20 Coontail
- 21 Elodea
- 22 Utricularia vulgaris
- 23 Bladderwort-mini
- 24 Buttercup
- 25 Naiad
- 26 Brittle naiad
- 27 Sago pondweed
- 30 Nymphaea
- 31 Nuphar
- 32 Brasenia
- 33 Lemna minor
- 34 Spirodella
- 35 Watermeal
- 36 Arrowhead
- 37 Pickerelweed
- 38 Arrow arum
- 39 Cattails
- 40 Bulrushes
- 41 Iris
- 42 Swamp loosestrife
- 43 Purple loosestrife

Density

- a Found
- b Sparse
- c Common
- d Dense

H₂O = 76°F

TOTALS †

☐ = 6.5 AC C₂SO₄/HYDROTICOL 191
(STARBUCK STONEWORT)

● = 5 AC C₂SO₄
(ALGAE)

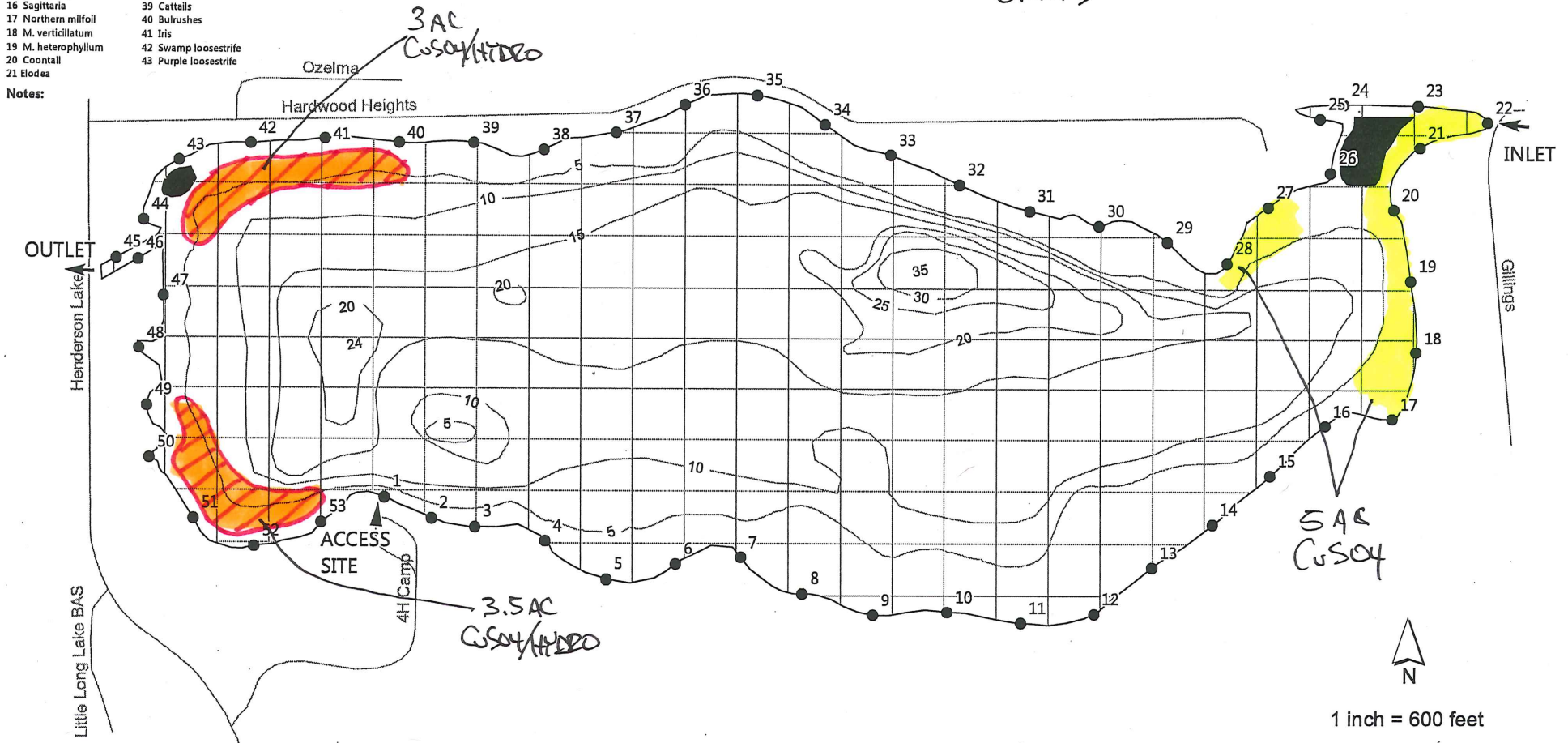

Notes: